



RAZER WOLVERINE V3 TOURNAMENT
EDITION

MASTER GUIDE

Get the edge you need to dominate the competition with the **Razer Wolverine V3 Tournament Edition**— our most advanced wired esports controller. Officially licensed by Xbox, perform like the pros on Xbox and PC with speed, control, and precision that sets you up for true gaming glory.

CONTENTS

1. WHAT'S INSIDE.....	3
2. WHAT'S NEEDED.....	4
3. LET'S GET YOU COVERED.....	4
4. TECHNICAL SPECIFICATIONS.....	5
5. GETTING STARTED	6
6. USING THE CONTROLLER	7
7. SAFETY AND MAINTENANCE.....	10
8. LEGALESE.....	11

1. WHAT'S INSIDE

- Razer Wolverine V3 Tournament Edition

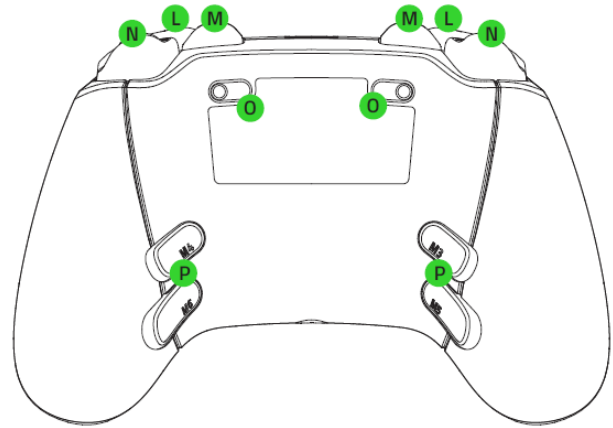
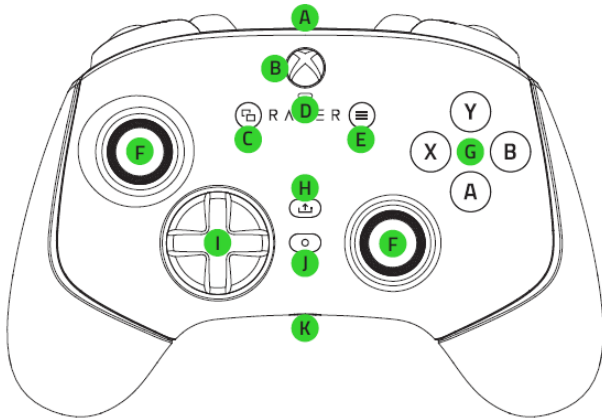

- A. Type C port
- B. Xbox button
- C. View button
- D. Status indicator
- E. Menu button
- F. Hall effect analog thumbsticks
- G. Razer Mecha-Tactile action buttons
- H. Share button
- I. Razer Mecha-Tactile 8-way floating D-pad

- J. Function button
- K. 3.5 mm headset port
- L. Bumpers (LB / RB)
- M. Multi-function claw grip bumpers (M1 / M2)
- N. Razer Pro HyperTriggers (LT / RT)
- O. Trigger stop switches
- P. Multi-function mouse click back paddles (M3 / M4 / M5 / M6)

- USB Type A to USB Type C cable

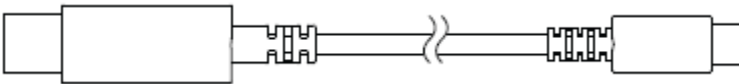

- Important Product Information Guide

2. WHAT'S NEEDED

PRODUCT REQUIREMENTS

- Xbox Series™ X|S or PC (Windows® 11 64-bit or higher)
- USB Type A port
- Internet connection for app installation

SAFETY STATEMENT

IMPORTANT! Before using your Xbox console with this product, read its instruction manual for safety, health, and other information regarding the use of your Xbox console.

3. LET'S GET YOU COVERED



Register your product and score exclusive benefits
razerid.razer.com/warranty

Got a question? Ask the Razer Support Team at support.razer.com

4. TECHNICAL SPECIFICATIONS

FEATURES

Connectivity	• Wired Connection
System Requirement	• Xbox or PC (Windows® 11 64-bit or higher) • Internet connection for Razer Controller app
Mechanical Action Buttons	• Razer Mecha Tactile Action Buttons
Multi-Function Buttons	• 4 Mouse Click Back Paddles • 2 Claw Grip Bumpers
Triggers	• 2 Hall Effect Analog triggers with Mouse Click trigger stops
Joysticks	• Anti-drift Hall Effect Analog thumbsticks
USB Cable	• 3 m / 10 ft USB C to USB A

5. GETTING STARTED

CONNECTING THE CONTROLLER

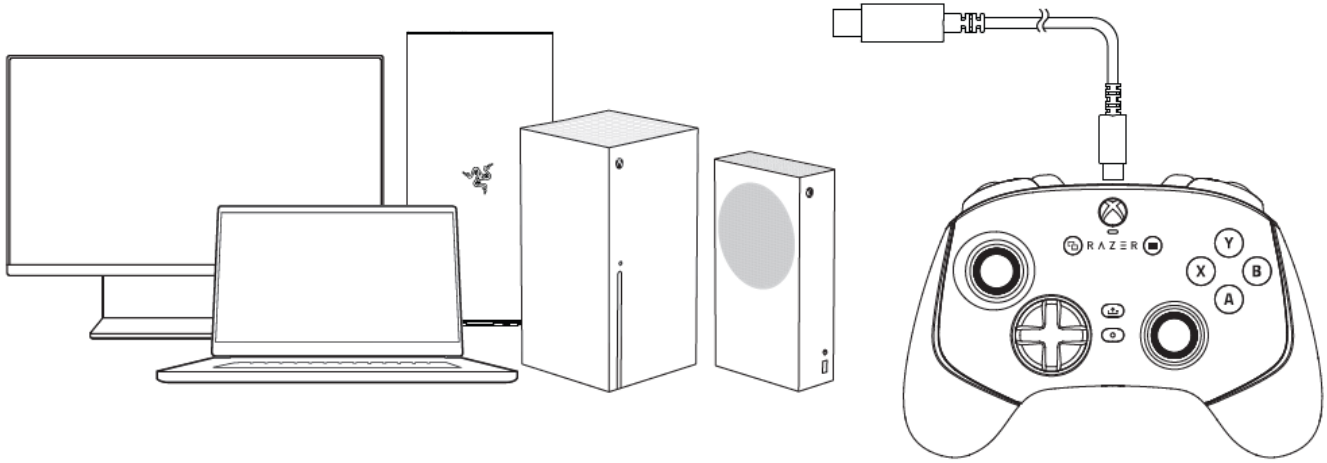

6. USING THE CONTROLLER



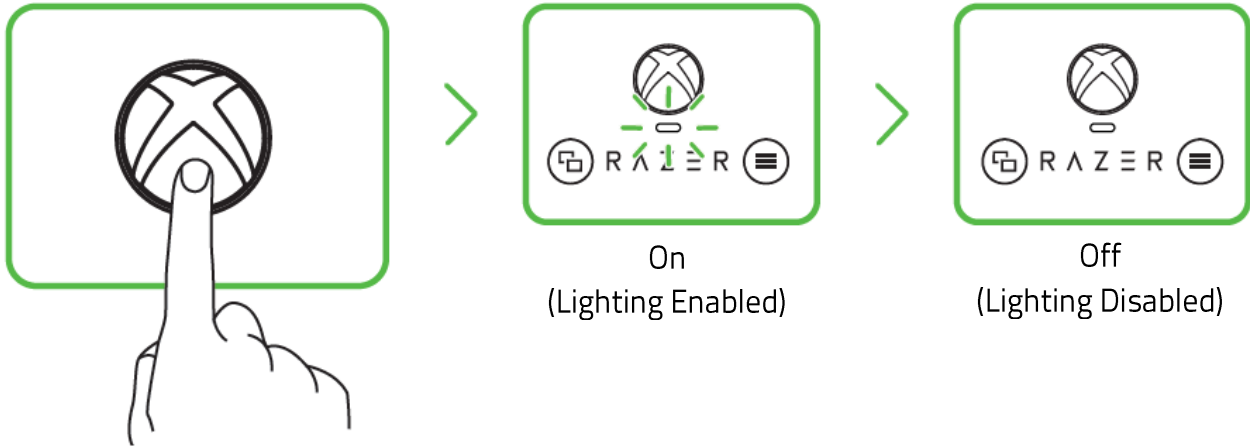

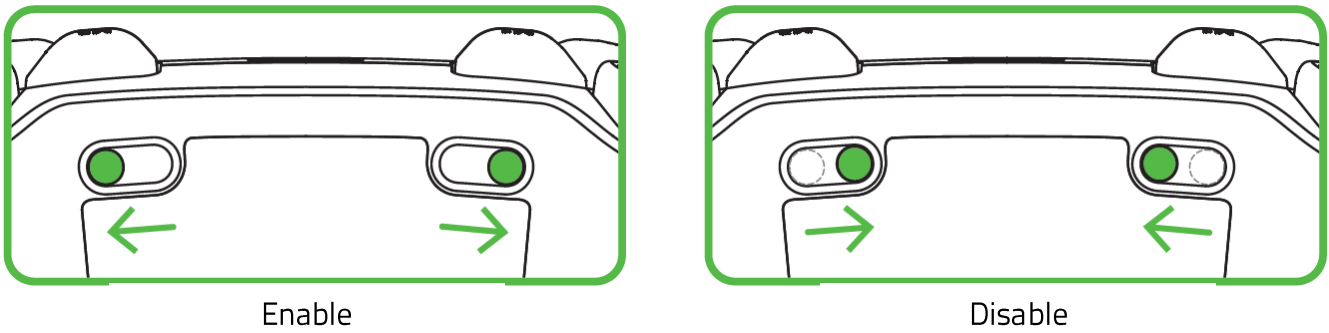

POWER ON/OFF



UTILIZING THE TRIGGER STOP SWITCHES



FUNCTION BUTTON COMMANDS

Input	Function
Hold  +  Press	Volume Up
Hold  +  Press	Volume Down
Hold  + RB Press	Increase Haptics Strength
Hold  + LB Press	Decrease Haptics Strength

DEFAULT MULTI-FUNCTION (M1-M6) MAPPING

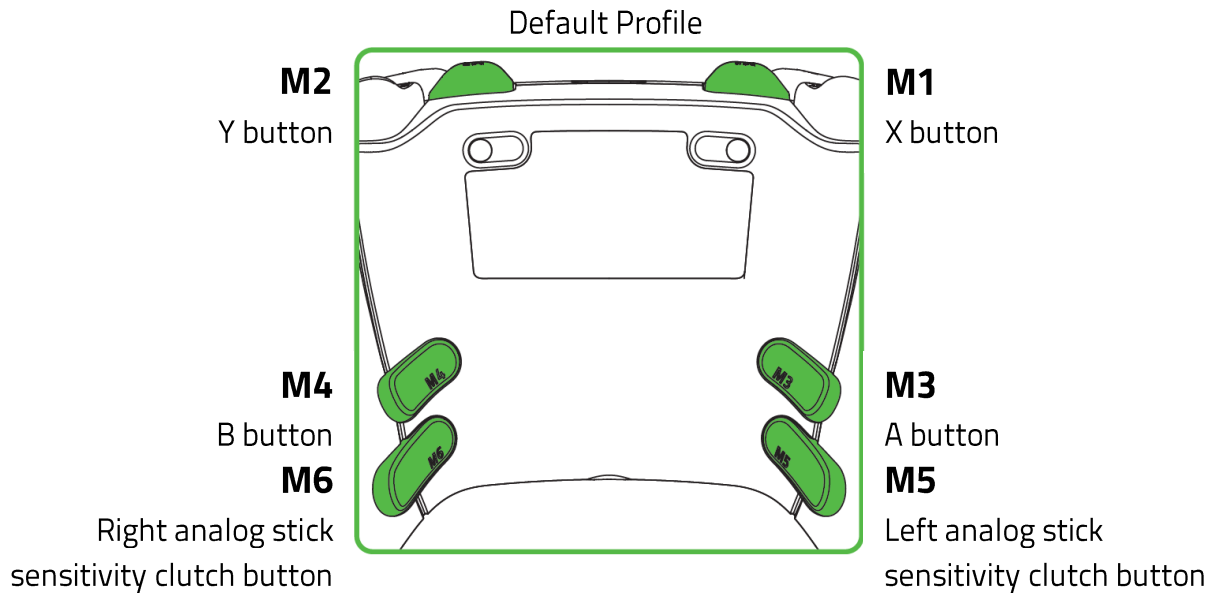

REASSIGNING THE MULTI-FUNCTION (M1-M6) MAPPING

1. Hold down the Function button and the Multi-Function bumper/paddle you want to remap.

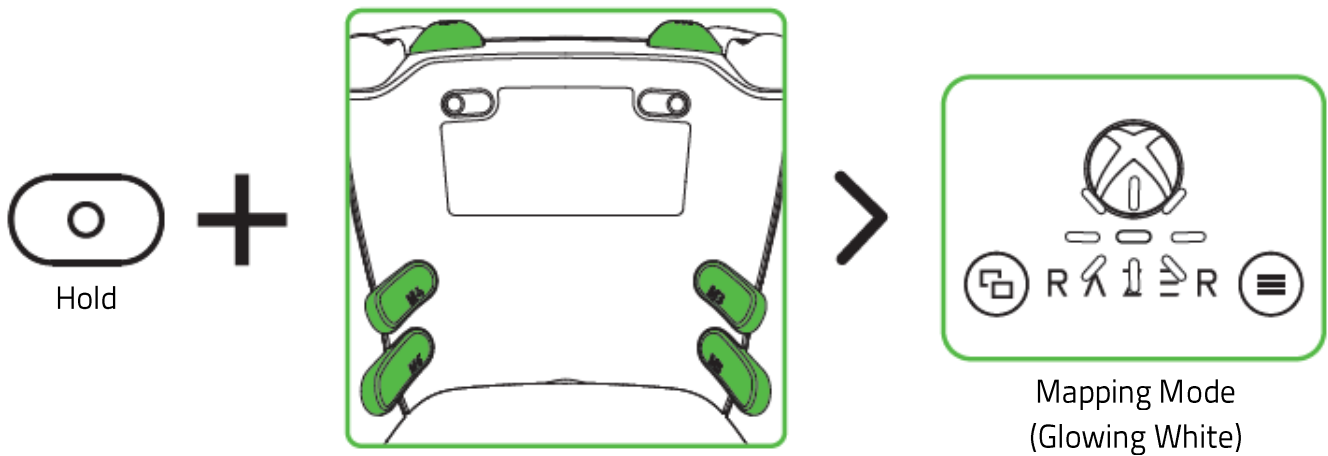

2. Press the button you want to assign to it.

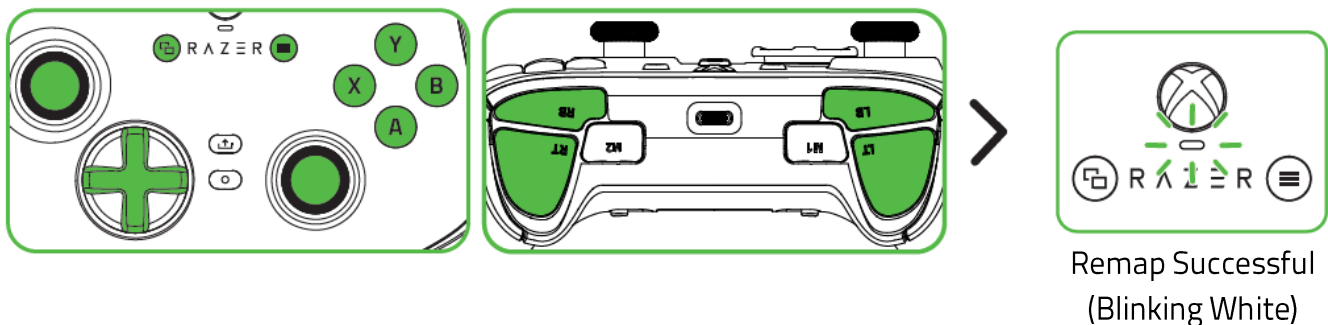

USING THE SENSITIVITY CLUTCH FUNCTION

Holding down the assigned button will lower the chosen analog stick's sensitivity by up to 50%.

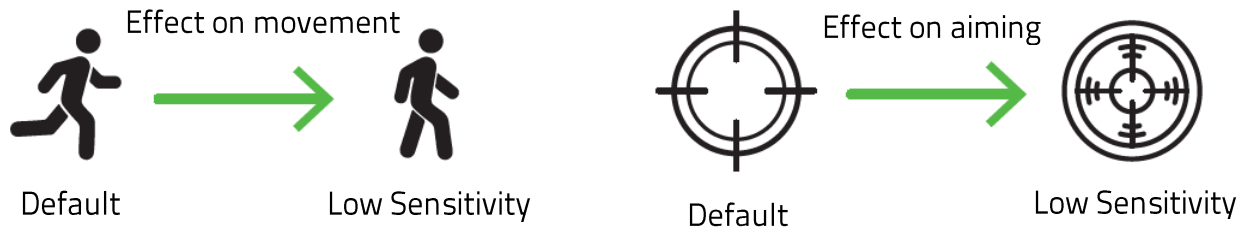

i *The sensitivity clutch function can be assigned and customized through the Razer Controller app.*

UNLOCK YOUR CONTROLLER'S FINAL FORM

Unleash your controller's full potential by installing the Razer™ Controller app on your Xbox Series™ X|S or PC to customize its sensitivity clutch settings, multifunction button assignments, and much more.



7. SAFETY AND MAINTENANCE

SAFETY GUIDELINES

In order to achieve maximum safety while using the Razer Wolverine V3 Tournament Edition, we suggest that you adopt the following guidelines:

Should you have trouble operating the device properly and troubleshooting does not work, unplug the device and contact the Razer hotline or go to support.razer.com for support. Do not attempt to service or fix the device yourself at any time.

Do not take apart the device and do not attempt to operate it under abnormal current loads. Doing so will void your warranty.

Keep the controller and all its parts and accessories out of the reach of small children to avoid accidents and/or injuries.

Keep the device and its components away from liquid, humidity or moisture. Operate the device and its components only within the specific temperature range of 0°C (32°F) to 40°C (104°F). Should the temperature exceed this range, unplug and switch off the device in order to let the temperature stabilize to an optimal level.

MAINTENANCE AND USE

The Razer Wolverine V3 Tournament Edition requires minimum maintenance to keep it in optimum condition. Once a month we recommend you unplug the device and clean it using a soft cloth or cotton to prevent dirt buildup. Do not use soap or harsh cleaning agents.

8. LEGALESE

COPYRIGHT AND INTELLECTUAL PROPERTY INFORMATION

©2024 Razer Inc. All rights reserved. Razer, the triple-headed snake logo, Razer logo, “For Gamers. By Gamers.” and “Razer Chroma” logo are trademarks or registered trademarks of Razer Inc. and/or affiliated companies in the United States or other countries.

Microsoft, Xbox, Xbox “Sphere” Design, Xbox Series X|S, Xbox One and Windows 11 are trademarks of the Microsoft group of companies. All other trademarks are the property of their respective owners.

Razer Inc. (“Razer”) may have copyright, trademarks, trade secrets, patents, patent applications, or other intellectual property rights (whether registered or unregistered) concerning the product in this guide. Furnishing of this guide does not give you a license to any such copyright, trademark, patent or other intellectual property right. The Razer Wolverine V3 Tournament Edition (the “Product”) may differ from pictures whether on packaging or otherwise. Razer assumes no responsibility for such differences or for any errors that may appear. Information contained herein is subject to change without notice.

LIMITED PRODUCT WARRANTY

For the latest and current terms of the Limited Product Warranty, please visit razer.com/warranty.

LIMITATION OF LIABILITY

Razer shall in no event be liable for any lost profits, loss of information or data, special, incidental, indirect, punitive or consequential or incidental damages arising in any way out of distribution of, sale of, resale of, use of, or inability to use the Product. In no event shall Razer’s liability exceed the retail purchase price of the Product.

GENERAL

These terms shall be governed by and construed under the laws of the jurisdiction in which the Product was purchased. If any term herein is held to be invalid or unenforceable, then such term (in so far as it is invalid or unenforceable) shall be given no effect and deemed to be excluded without invalidating any of the remaining terms. Razer reserves the right to amend any term at any time without notice.